



LONDON
WORK AT HEIGHT
SEMINAR

10 JULY 2017



ABOUT LWAHS 2017

The London Work At Height Seminar 2017 builds on the success of the highly regarded inaugural 2016 event; and we are again delighted to have the opportunity to host London City's annual Work at Height Seminar at the prestigious Guildhall.

The Seminar provides opportunity for our industry to collaborate in the interest of safety awareness, best practice and knowledge sharing; and to demonstrate a variety of our Work at Height methodologies and industry innovations. The event is largely aimed at Local Government Authorities, Procurement Professionals, Health & Safety Professionals, Building & Facilities Managers and all other professionals who have an interest in Working at Height within the City of London and beyond.

PRESENTERS

Coupled with noteworthy representation from the City of London Corporation, this year we warmly welcome key speakers representing member organisations of the Access Industry Forum (AIF) and a variety of leading safety and Work at Height experts. Read on for full details.

DEMONSTRATIONS

In the 'Courtyard' area of the Guildhall, we will be demonstrating equipment in use and various Working at Height methods. Additionally, a selection of manufacturers will be displaying their systems and equipment throughout the day.

We take this opportunity to thank the City of London Corporation for supporting this pivotal event.

We look forward to seeing you there!

Kind regards,

LWAHS Team.



ORGANISER



Speaker: Jeremy Simons

Jeremy Simons worked in the City for a major UK telecommunications company. He was elected to the Court of Common Council in 2004 to represent Castle Baynard and is a resident of the Ward. He has a degree in Physics from Nottingham University and an MSc from Imperial College London. Jeremy's interests include current affairs, music and travel.

He is a Liveryman of the Worshipful Company of Scientific Instrument Makers and a member of the Castle Baynard and Farringdon Ward Clubs. He is also a trustee of a number of local charities. He is currently the Chairman of the Port Health & Environmental Services Committee.

Speaker: Toby Thorp

Toby is a Chartered Environmental Health Practitioner working at the City of London Corporation with an MSc. in Environmental Health and a PgDip in the Science of Health, Safety and the Environment. He tries to add to that daily with as much real world experience as possible. He joined the specialist H&S team at the City Corporation in 2007 and every day continues to learn about the unique world that is the Square Mile. He is a Primary Authority partner for a property management company, a cross-sector facilities services provider and several gym chains.

He has contributed to a number of national health and safety guidance documents, represents Local Authorities on the Legionella Control Association Management Committee and is a founding member of the Leisure Expert Panel. Along with his colleagues, he has been working to deliver the City's Work at Height strategy for several years and, despite being a regulator, is keen on driving improvement in work at height practices through non-enforcement means such as partnership working and influencing the supply chain.



ORGANISER



Chairman/Speaker: Graham Burnett

Graham Burnett has represented a prominent IRATA Member Company for over 25 years, he was previously an assessor, level 3 technician and an overall major contributor to the advancement of IRATA globally. Graham has held positions on all IRATA committees and has played a pivotal role in the compilation of the original 'IRATA Guidelines', including all revisions, 'IRATA International Code of Practice', 'IRATA Training, Assessment and Certification Scheme', 'The Rope Access Wind Energy Guidance Document' and the most recent 'Rope Access Manager Rope Access Safety Supervisor' Scheme.

Industrial rope access, as trained for and operated by the member companies of IRATA International, has come a long way in its 28 years. From the point where it was created to meet a specific need to solve maintenance problems in the offshore industry, rope access has distinguished itself as an integral part of the work-at-height sector around the world and has achieved this alongside a safe working record that is unrivalled in this sector. This in turn has earned the admiration of the markets it serves and the men and women its members employ.

The work solutions it offered the oil and gas industry has proved so adaptable in this sector that the tasks its members now complete offshore are more varied and substantial than the basic maintenance work that was typical back in the 1990s. Indeed, such are the advantages that rope access offers that it has proved itself to be able to undertake major projects that have been beyond other access methods. Furthermore, IRATA rope access is the required partner for many of the leading global and national offshore companies and offers its services around the world.

The solutions IRATA offered offshore also proved to be valuable onshore and technicians on ropes have, for many years, been offering a vast portfolio of work in a wide range of repair, maintenance, inspection and other access work. Today, IRATA teams are at work in every continent and as likely to be seen on the world's iconic sites as they are in your local town or industrial site.



PRESENTERS



**ALLFORD
HALL
MONAGHAN
MORRIS**

Guest Speaker: Ray Cooke

Ray Cooke is a principal inspector with HSE, and is head of the construction sector safety team. He joined HSE in 1985 and has inspected many different industries including specialising in docks, shipbuilding and shiprepair, woodworking, plastics, food, health services and fairgrounds.

As well as being an inspector Ray has undertaken a wide variety of other roles, having been lead HSE negotiator on the ATEX Directive (which led to the DSEAR Regulations), partnership manager leading liaison with local authorities in the Midlands, run the construction team in Birmingham and been responsible for training new inspectors, before moving into his current role.

Guest Speaker: Paul Bussey

Paul is a Senior Technical Consultant at AHMM who has worked in architectural practices for over 35 years, on many types and sizes of projects in a variety of roles including job running, whilst developing a technical expertise in the application of all types of building related legislation and constructional guidance. He is a London representative of the in-house Technical team who research current and best practice technical solutions in regulatory compliance and thereby assist the project teams to meet their statutory and contractual obligations on all projects. Paul has established a track record of assisting professional design teams in delivering outstanding and innovative design solutions whilst still achieving compliance within the increasing burden of legislation and technical guidance that prevails in our modern society.

Paul is leading the way for the RIBA to embed the role of Principal Designers into everyday architectural practice by his authorship of a book entitled "CDM 2015- A Practical Guide for Architects and Designers" and developing and delivering a course for Architectural Principal Designers.

www.hse.gov.uk

www.ahmm.co.uk



PRESENTERS



ATLAS The Association of Technical Lightning & Access Specialists

The Association of Technical Lightning & Access Specialists (ATLAS) has been representing the leading players in the lightning protection and steeplejack industry since 1946. At the forefront of all industry developments, ATLAS is committed to improving working practices, technical excellence and the skills of the workforce to provide the highest quality service to the industry's clients. Lightning protection and specialist access are highly specialised trades which should only be undertaken by qualified specialist contractors in order to guarantee quality work that is compliant with industry recognised standards.

www.atlas.org.uk



The British Safety Industry Federation (BSiF) is the lead association for the Personal Protective Equipment (PPE) Directive and is recognised as a Competent Authority by the Health & Safety Executive (HSE). The BSiF has active links with many government departments and represents 175 member organisations. The BSiF is firmly established as the major independent voice of the British safety industry, helping to both influence legislation and provide industry in general with a source of authoritative information on a range of workplace issues while representing the needs of its members.

www.bsif.co.uk



PRESENTERS



The Edge Protection Federation exists to provide the industry with a single, authoritative body to act as a representative voice and ensure that high standards in manufacture, supply and application of edge protection systems are maintained and advanced. With increased emphasis on working at height and other areas of health and safety, the federation aims to offer a forum for the discussion of industry issues, liaison with governmental and other bodies involved in legislation and regulation across the construction industry, guidance on all developments that affect the industry sector, and training programmes and publications relevant to the industry.

www.epf-uk.org

FASET

Fall Arrest Safety Equipment Training

FASET (Fall Arrest Safety Equipment Training) is the international trade association and training body for the safety net rigging and fall arrest industry. It represents all the leading manufacturers and installers of safety nets which are used to save lives and reduce injuries on site by absorbing energy from a falling body. FASET's fast-expanding network of approved and audited training centres provides the only recognised training route for anyone wishing to install, inspect and maintain safety nets, or obtain a CSCS Safety Net Rigger Card. Together with its members, FASET is helping to secure a safer, more professional and more competent approach to working at height.

www.faset.org.uk



The International Powered Access Federation (IPAF) promotes the safe and effective use of powered access equipment worldwide. It provides technical advice and information, influences and interprets legislation and standards, and runs safety initiatives and training programmes. It is a not-for-profit organisation owned by its members who include manufacturers, rental companies, contractors and users. IPAF's training programme for platforms operators is certified by TÜV as conforming to ISO 18878. More than 100,000 operators are trained each year through a worldwide network of over 600 IPAF-approved training centres. Successful trainees are awarded the PAL Card (Powered Access Licence), the most widely held and recognised proof of training for platform operators.

www.ipaf.org



The Ladder Association promotes and champions the ladder as an invaluable piece of workplace equipment and is the only trade body dedicated to providing users with the information and skills they need to use ladders and stepladders safely and productively. Working in collaboration with manufacturers, suppliers, key influencers and policy makers, including the Health & Safety Executive (HSE), the association uses the collective experience and expertise of its many members to fulfil a number of key roles. As a knowledge provider and resource centre, its safety-related publications, products and website cover all aspects of safety and best practice, and its training courses deliver confidence and competence as required by the Work at Height Regulations. In addition, specialist committees contribute to the setting of both national and European standards.

www.ladderassociation.org.uk



PRESENTERS



Since its formation in 1945, the NASC has worked closely with stakeholder partners in the UK construction industry to promote the highest possible standards in work at height. Health and safety and training have always been of paramount importance on the Confederation's agenda, and this is reflected in the scope and range of new and revised industry guidance produced by the NASC. For over 40 years the industry training scheme CISRS has been the recognised qualification for those working within the UK scaffolding and access sector. The scheme is constantly being refined and developed and will be introducing CPD in June 2017. The NASC plays a full and active part in the continuing development of the Access Industry Forum.

www.nasc.org.uk



PASMA is the world's lead trade association for the mobile access tower industry. Representing the interests of manufacturers, suppliers, specifiers and users, it delivers and oversees the industry standard training scheme and is a major publisher of safety-related knowledge, information and guidance. Its training courses are widely acknowledged as the industry standard and almost every workplace now insists on the PASMA ID card as the only proof of competence when it comes to erecting, inspecting, moving and dismantling towers. Liaising closely with all the key regulatory authorities and standards-setting bodies in the work at height sector, it is the voice of the industry and, as such, plays a leading role in promoting best practice.

www.pasma.co.uk



SAEMA members are recognised experts in the design, installation and maintenance of both temporarily and permanently installed facade access systems that provide safe places of work for tradesmen involved in working at height. Liaising closely with other specialist and standards-setting bodies, SAEMA participates in the development of national and international standards, and is actively engaged in advancing the height safety agenda through training and the furtherance of best practice guidance. Equipment supplied by SAEMA members can be either permanently installed – for the lifetime of a building or bridge – or temporarily installed for the construction phase of a project or the on-going maintenance of buildings or structures.

www.saema.org



Work at Height Safety Association was incorporated in 2005 by the manufacturers of personal fall protection equipment used for work at height and rescue. WAHSA Members are the unquestionable experts in the field, and provide a benchmark in high standards for the manufacture and subsequent use of members' products, and take the lead role in the setting of standards and codes of practice for the use of such equipment within the UK and Europe. WAHSA takes a proactive role to educate and inform people at all levels of the supply chain to ensure that fall protection equipment is purchased, provided and used in a competent and professional manner.

www.wahsa.org.uk



PRESENTERS



DROPS

**DAVID
GRAHAM**

Dropped Objects Prevention Scheme

Within the oil and gas industry, everyone knows the potential cost of a dropped object. It's not just about equipment damage and lost production. It's about life!

The problem is common to everyone in the industry, across all regions, sectors and disciplines. DROPS is an industry-wide initiative focused on preventing dropped objects, with the ultimate goal of delivering a second nature dropped objects prevention strategy across our industry.

DROPS is essentially a Global Work Group, represented by 200 operators, contractors, service companies and industry bodies, all sharing commitment and enthusiasm for the common goal of dropped object prevention.

A Working at Height subject matter expert, NEBOSH, TECHIOSH and ISO lead auditor. David is the past Chairman of the IRATA Regional Advisory Committee for north sea oil & gas rope access operators and has worked within the rope access industry for circa 20 years; holding positions of Senior Operations Manager and Technical Authority for one of the largest fabric maintenance companies in Northern Europe.

David is an accomplished health and safety practitioner who operates within a challenging health and safety department. He is the principal author of his company's health and safety standards, processes and procedures. David is also an active safety coach and safety mentor.

www.dropsonline.org



10 JULY 2017

MORNING PROGRAMME

TIME	ORGANISATION	SPEAKER
09:00 - 09:50	Welcome and Registration	Adam Wainwright
09:50 - 10:05	City of London Corporation	Jeremy Simons
10:10 - 10:25	Health & Safety Executive - Construction Safety Unit	Ray Cooke
10:30 - 10:45	City of London Corporation	Toby Thorp
10:50 - 11:05	AHMM Architects	Paul Bussey
11:10 - 11:25	Industrial Rope Access Trade Association (IRATA International)	Graham Burnett
11:30 - 11:45	Technical Lightning and Access	ATLAS
11:50 - 12:05	Personal Protective Equipment	BSIF
12:10 - 12:25	Edge Protection Systems	EPF
12:30 - 13:20	Lunch Break	

CONTINUES ON NEXT PAGE →



10 JULY 2017
AFTERNOON PROGRAMME

TIME	ORGANISATION	SPEAKER
13:30 - 13:45	Fall Arrest Safety Nets	FASET
13:50 - 14:05	Mobile Elevating Work Platforms	IPAF
14:10 - 14:25	Ladders and Stepladders	The Ladder Association
14:30 - 14:45	Scaffolding and Access	NASC
14:50 - 15:05	Coffee Break	
15:15 - 15:30	Mobile Access Towers and Podiums	PASMA
15:35 - 15:50	Temporary/ Permanent Façade Access	SAEMA
15:55 - 16:10	Protection and Rescue Equipment	WAHSA
16:15 - 16:30	Occupational Health Factors Whilst Working at Height	David Graham
16:35 - 16:50	Dropped Objects Prevention Scheme	DROPS



THE VENUE

London Guildhall

Steeped in tradition, Guildhall invites guests on a journey spanning more than 800 years - from the Gothic grandeur of the Great Hall to the largest surviving medieval crypts in London. Home to the City of London Corporation, Guildhall is a remarkable backdrop to national celebrations, corporate entertainment and major conferences. Seven flexible function spaces offer unique settings for large and small scale events, daytime or evening, right at the heart of the City.

Guildhall hosts many events throughout the year, the most notable one being the Lord Mayor's Banquet, which is held in honour of the immediate-past Lord Mayor and is the first to be hosted by the new Lord Mayor of the City of London. In keeping with tradition, it is at this Banquet that the Prime Minister makes a major World Affairs speech. One of the last acts of the outgoing Lord Mayor is to present prizes at the City of London School prize day at Guildhall. Other events include those of various law firms, award evenings for the Wine and Spirit Education Trust (WSET), and the banquet for the International Wine and Spirit Competition (IWSC).

Situated directly beneath the Old Library, the Livery Hall shares many of its fine Victorian Gothic features. Designed by Sir Horace Jones in 1872, the Grade II listed Livery Hall was used as a museum until the outbreak of the Second World War. The contents were removed for safe-keeping but were never returned, later being transferred to the Museum of London. Restored as an events space and reopened in 2008, the room was renamed the Livery Hall to reflect the City of London's Livery ties. Coloured lighting beautifully illuminates the architecture, and a purpose-built kitchen, servery, lift and cloakroom facilities immediately adjoin the room.

*in www.guildhall.cityoflondon.gov.uk/
www.en.wikipedia.org/wiki/guildhall,_london*



EXHIBITIONS

The Crypt

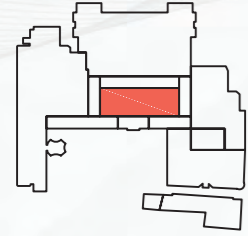

Overview key plan of Guildhall
(specific area highlighted in red)

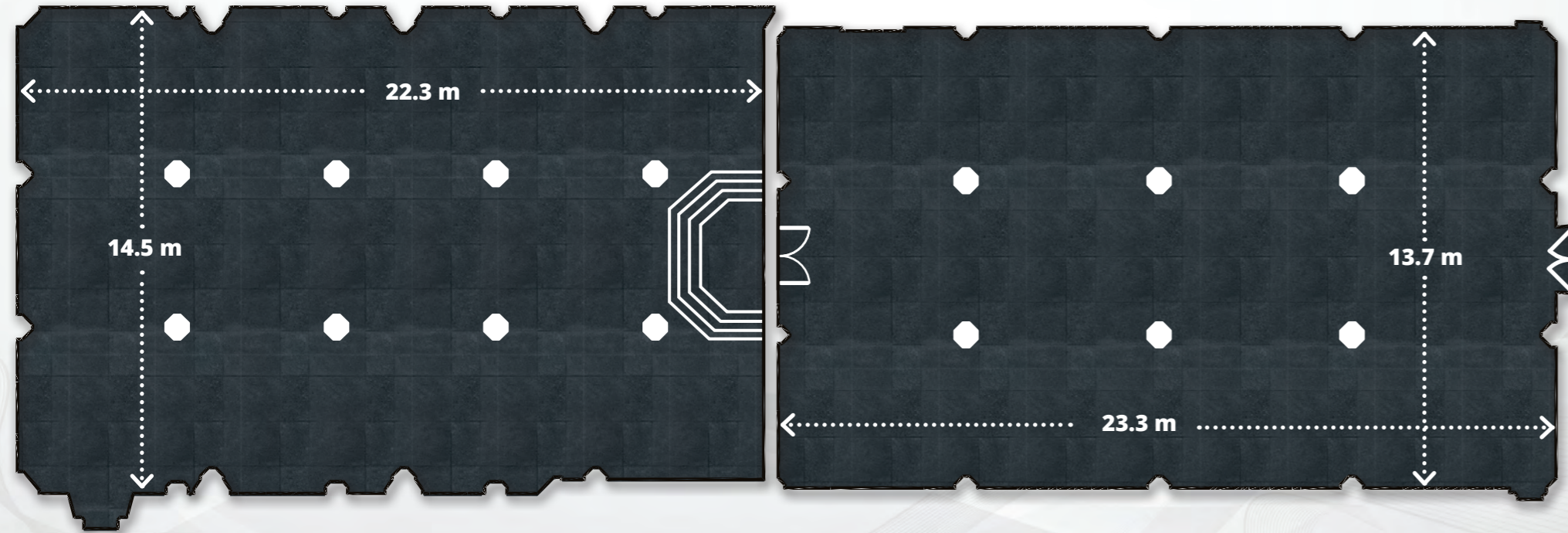

West Crypt

West Crypt Area = 317.9 sqm
East Crypt Area = 315.9 sqm
All dimensions shown are approximate



DEMONSTRATIONS

Guildhall Courtyard

Guildhall Yard

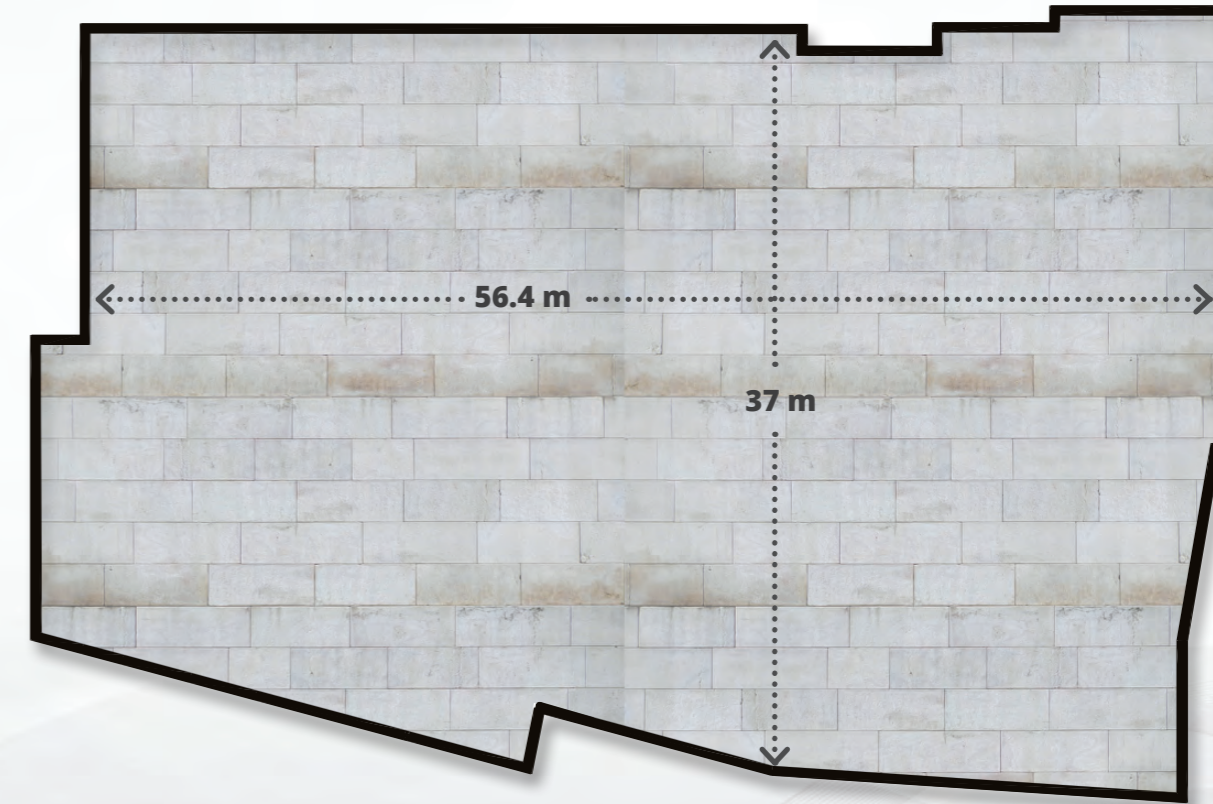

Guildhall Yard Area = 2022 sqm
All dimensions shown are approximate



LONDON WORK AT HEIGHT SEMINAR
info@lwahs.co.uk

The work contained herein is protected by copyright © 2017 LWAHS, it should not be reproduced, copied, edited or published without written permission from the copyright owner. Any questions or doubts concerning permissible use must be directed to info@lwahs.co.uk. All rights reserved.